

TM9-2320-211-34P  
 (1) (2) (3) (4) (5) (6) (7) (8) (9) (10)  
 SMR Federal DESCRIPION UNIT OF MEASUREMENT UNIT OF MEASUREMENT UNIT OF MEASUREMENT UNIT OF MEASUREMENT  
 Code Stock Code Stock Code Stock Code Stock Code Stock Code Stock Code Stock Code Stock Code  
 Number Number Number Number Number Number Number Number Number Number  
 of inc. allowance allowance allowance allowance  
 meas in Unit per alw per alw per alw per alw  
 100 per (a) (b)  
 equip100 Figure Item  
 cnt- equipNo. No.  
 Reference Number & Mfr. Code Usable On Code 1-20 21-5(51-10(1-20 21-5(51-10(gcy

Current part is item (1) on diagram. Available at [www.oshkoshequipment.com](http://www.oshkoshequipment.com)

1601-SPRINGS-CONTINUED

Code	Part Number	Description	Unit	Meas	Inc	Allow	Allow	Allow	Allow	Per	Per	Per	Per
P-O	5310-012-03	NUT, SELF-LOCKING: 120371 (21450)	HA, JA BD	EA	2	*	*	*	*	*	*	125	12
P-O	5310-957-71	NUT, SELF-LOCKING: MS35691-705 (96906)	A	EA	4	*	*	*	*	*	*	125	13
P-O	5305-717-39	SCREW, CAP, HEXAGON: MS90725-103 (96906)	A	EA	4	*	*	*	*	*	*	125	14
P-O	5310-740-96	WASHER, FLAT: 7409615 (19207)	A	EA	2	*	*	*	*	*	*	126	1
P-O	5330-740-93	WASHER, NONMETALLIC: 7409312 (19207)	A	EA	3	*	*	*	*	*	*	126	2
P-O	2510-740-96	RETAINER, PACKING: SEAT BEARING FELT 7409606 (19207)	A	EA	2	*	*	*	*	*	*	126	3
P-O	2530-740-95	RING, WIPER: HUB BEARING OIL SEAA 7979766 (19207)	A	EA	2	*	*	*	*	6	10	126	4
P-O	2520-740-95	SEAL, PLAIN, ENCASED: SEAT BEARING 7409550 (19207)	A	EA	2	*	*	*	*	10	200	126	5
P-O	3110-198-14	CONE AND ROLLERS, TAPERED: 712286 (21450)	A	EA	2	*	*	*	*	8	10	126	6
P-O	5306-740-96	BOLT, MACHINE: SPRING SEAT 7409608 (19207)	A	EA	4	*	*	*	*	6	10	126	7
X2-O		WASHER, LOCK: SPRING SEAT 131050 (21450)	A	EA	4	*	*	*	*			126	8
P-O	2510-741-87	SEAT ASSEMBLY, BEARING CUP: 7418773 (19207)	A	EA	2	*	*	*	*	8	10	126	9
P-O	3110-142-43	CUP, TAPERED ROLLER BEARING: 706691 (12742)	A	EA	2	*	*	*	*	6	10	126	10
P-O	3110-100-06	CONE AND ROLLERS, TAPERED: 705155 (12742)	A	EA	2	*	*	*	*	6	10	126	11
P-O	5310-353-22	NUT, PLAIN, OCTAGON: 7409603 (19207)	A	EA	2	*	*	*	*	6	10	126	12
PO	5310-700-70	WASHER, KEY: SEAT NUT 7007089 (19207)	A	EA	2	*	*	*	*	6	10	126	13
P-O	5310-353-24	NUT, PLAIN, OCTAGON: 7346885 (19207)	A	EA	2	*	*	*	*	6	10	126	14
P-O	2510-740-96	GASKET: SEAT BEARING CAP 7409600 (19207)	A	EA	2	*	*	*	*	10	200	126	15
P-O	2510-740-93	COVER, ACCESS: 7409391 (19207)	A	EA	2	*	*	*	*	3	5	126	16

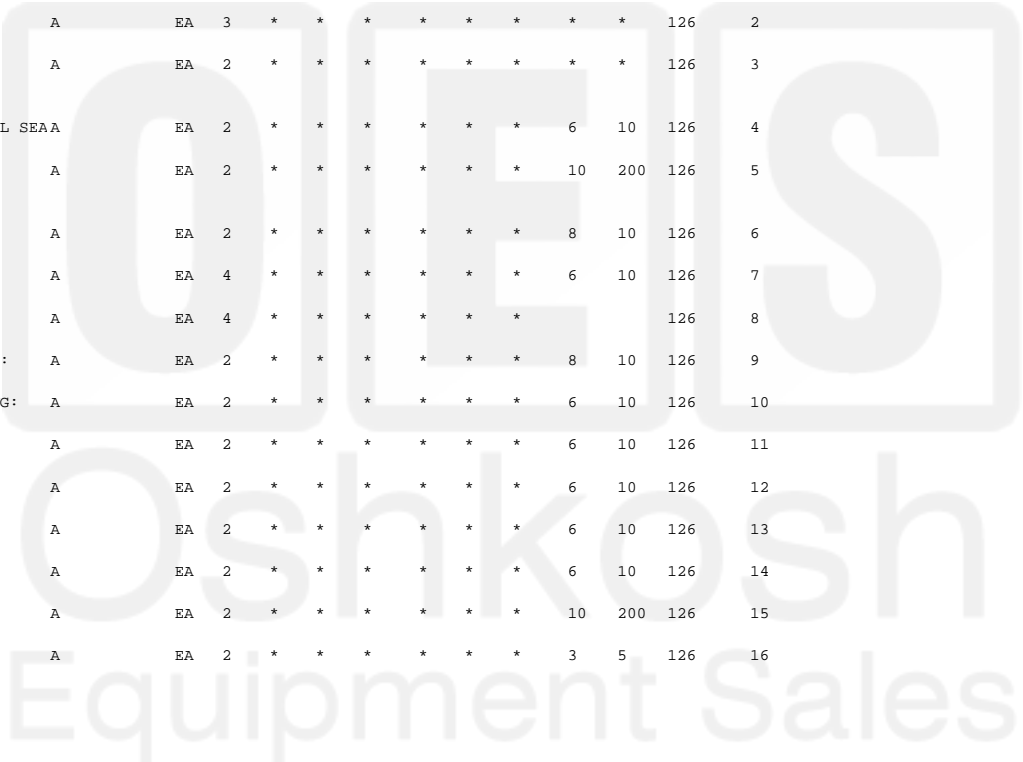

Current part is item (1) on diagram. Available at [www.oshkoshequipment.com](http://www.oshkoshequipment.com)

Current part is item (1) on diagram. Available at [www.oshkoshequipment.com](http://www.oshkoshequipment.com)

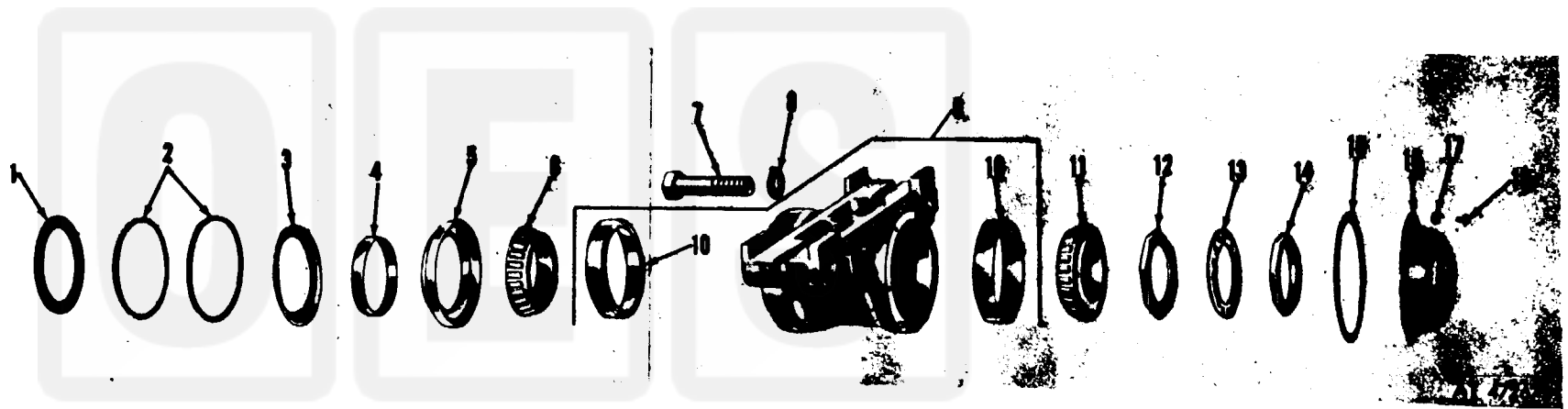

*Figure 126. Rear spring seat and bearing.*

Oshkosh  
Equipment Sales

Current part is item (1) on diagram. Available at [www.oshkoshequipment.com](http://www.oshkoshequipment.com)